



Enquiries: Ph (08)9222 3518 Fax (08)9222 3452  
Email: s24md.infrastructure@dmpe.wa.gov.au

NATIVE TITLE SERVICES GOLDFIELDS(ARB13)  
PO BOX 464  
WEST PERTH WA 6872



22 May 2026

Dear Sir/Madam

**NOTIFICATION OF AN INFRASTRUCTURE FACILITY ASSOCIATED WITH MINING PURSUANT TO SECTION 24MD(6B)(D) COMMONWEALTH NATIVE TITLE ACT 1993**

No	Applicant/s	NTP/s	NTRB/s
L 39/394	SATURN METALS LIMITED	Determined Area(s): - Nyalpa Pirniku WCD2023/002	NATIVE TITLE SERVICES GOLDFIELDS(ARB13)
L 40/54	SATURN METALS LIMITED	Determined Area(s): - Nyalpa Pirniku WCD2023/002	NATIVE TITLE SERVICES GOLDFIELDS(ARB13)
L 40/55	SATURN METALS LIMITED	Determined Area(s): - Nyalpa Pirniku WCD2023/002	NATIVE TITLE SERVICES GOLDFIELDS(ARB13)

No	Area	Locality	Centroid	Shire
L 39/394	336.30 HA.	50.7km SE'ly of Leonora	Lat: 29° 9' S Long: 121° 45' E	LEONORA SHIRE, MENZIES SHIRE
<b>The purposes of L 39/394 are: a bore, a bore field, a communications facility, a drainage channel, a pipeline, a power generation and transmission facility, a power line, a pump station, a road, a water management facility, a workshop and storage facility</b>				
L 40/54	3.46 HA.	43.8km SE'ly of Leonora	Lat: 29° 13' S Long: 121° 33' E	MENZIES SHIRE
<b>The purposes of L 40/54 are: a bore, a bore field, a communications facility, a drainage channel, a pipeline, a power generation and transmission facility, a power line, a pump station, a road, , a water management facility, a workshop and storage facility</b>				
L 40/55	90.22 HA.	45.8km SE'ly of Leonora	Lat: 29° 13' S Long: 121° 36' E	MENZIES SHIRE
<b>The purposes of L 40/55 are: a bore, a bore field, a communications facility, a drainage channel, a pipeline, a power generation and transmission facility, a power line, a pump station, a road,, a water management facility, a workshop and storage facility</b>				

You are hereby notified in your capacity as a registered native title claimant, native title body corporate or a representative Aboriginal Torres Strait Islander Body that application has been made for the tenement/s listed for the sole purpose of the construction of an infrastructure facility associated with mining (as defined in Section 253 of the Commonwealth *Native Title Act 1993 (Cth)* (NTA)) for an initial term of 21 years. I would also inform you that subject to the completion of any relevant processing under the Mining Act 1978 (WA) and Section 24MD(6B) under the NTA that there is an intention that the licence/lease be granted.

Plan/s showing the location of the application(s) is/are enclosed.

In accordance with Section 24MD(6B)(d) any registered native title claimant or registered native title body corporate may object within two months of notification, to the grant of the licence/lease by **29 July 2026** so far as it affects their registered native title rights and interests in relation to land or waters to which the lease/licence relates.

The licence/lease applicant must consult any registered native title claimants and native title bodies corporate who object, about ways of minimising the impact of the grant of the licence/lease on registered native title rights and



**Department of Mines,  
Petroleum and Exploration**

interests in relation to the land or waters. If relevant the applicant must also consult about any access to the land or the way in which anything authorised by the grant of the lease/licence might be done.

Any objection lodged by a registered native title claimant or by a registered native title body corporate is to be in the form of a letter addressed to or delivered to the General Manager Resource Access, Locked Bag 100, East Perth WA 6892 and must be received before the close of business at 4.30pm on **29 July 2026**. The objection must contain the following information:

- number of the Miscellaneous licence/General Purpose lease objected to;
- details of how the grant of the licence/lease will affect the objector's registered native title rights and interests in relation to the land or waters affected; and
- the name, claim number and address for service of the registered native title claimant or registered native title body corporate

Should you require any further information on DMPE procedures please contact Resource Access Branch on (08)9222 3518.

Yours sincerely

**Zoran Vukojevic**  
GENERAL MANAGER  
RESOURCE ACCESS BRANCH

Att



# L 40/54 Native Title Act 1993 (Cth) Notification Plan

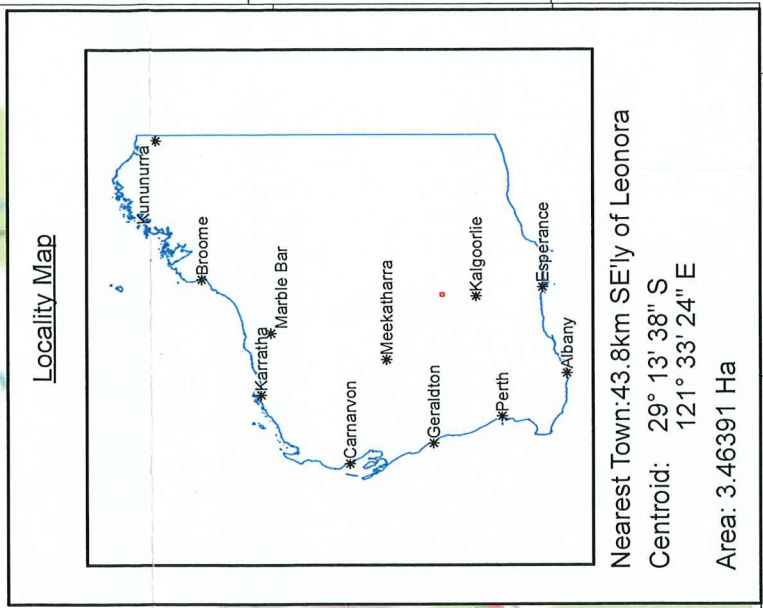
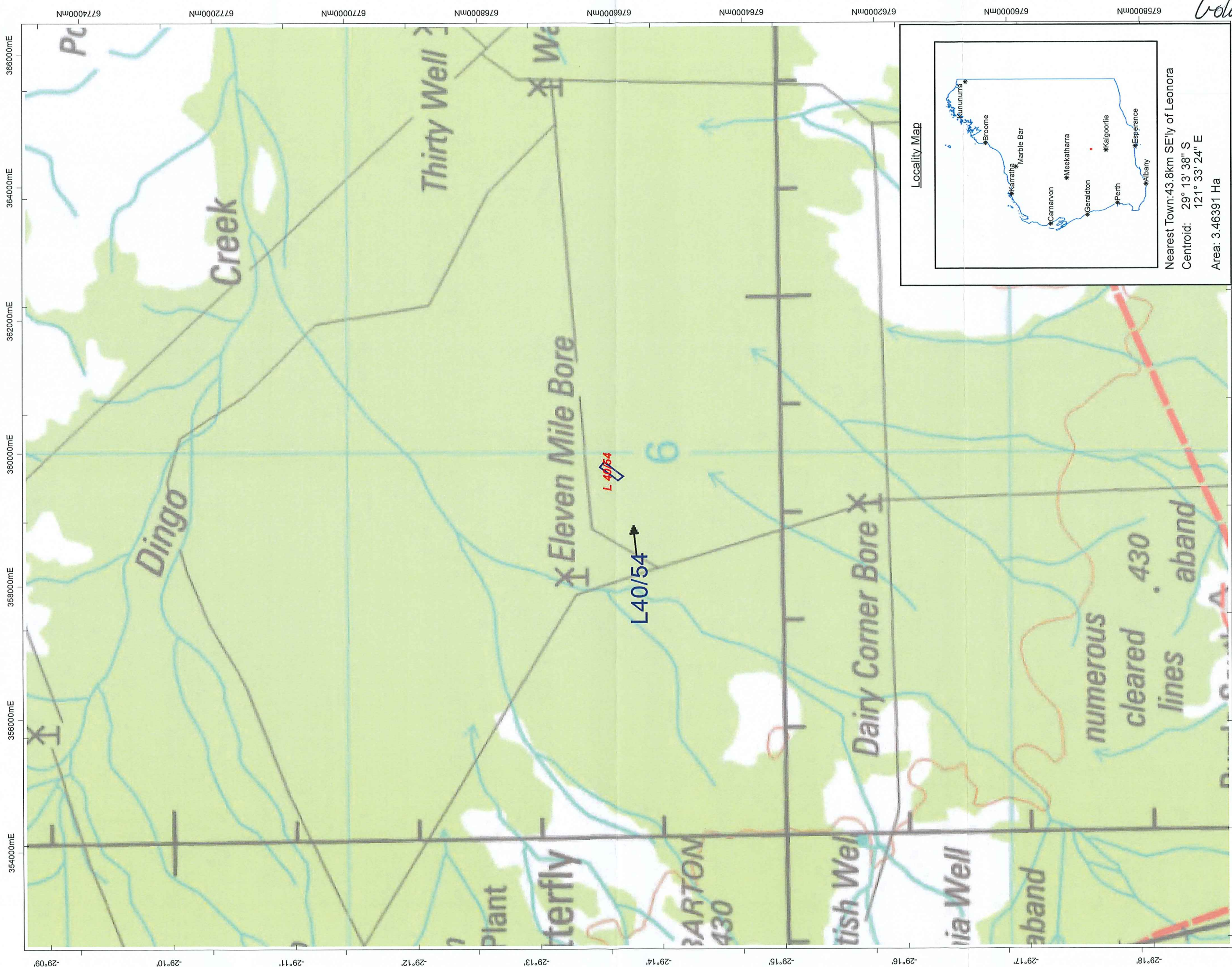

This plan has been compiled from various data sources received from a number of agencies and with information provided by the landowners. It is not intended to be used for any purpose other than the purposes for which it was prepared. Users wishing to use this plan for any other purpose should contact the Department of Mines, Petroleum and Exploration. The Department of Mines, Petroleum and Exploration is not responsible for any loss or damage arising from the use of this plan. The Department of Mines, Petroleum and Exploration is not responsible for any loss or damage arising from the use of this plan. The Department of Mines, Petroleum and Exploration is not responsible for any loss or damage arising from the use of this plan.

Goldfields

# L 40/55 Native Title Act 1993 (Cth) Notification Plan

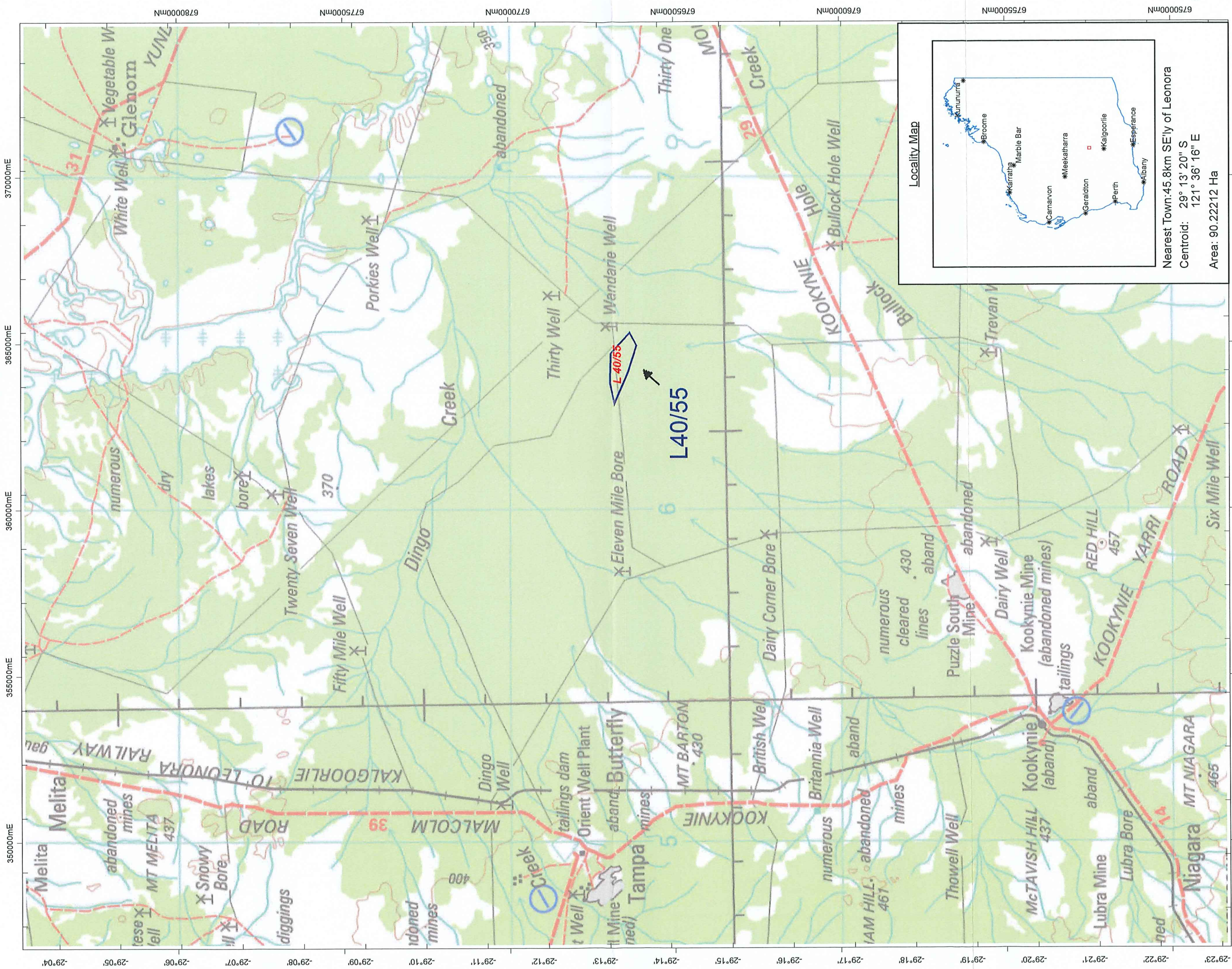

This plan has been created from various data sources received from a number of agencies and each information supplied by applicants for mining tenements. No responsibility is accepted for any error or omission. The information is provided for general information only and should not be used for any purpose other than that for which it is provided. The data is the unaltered form of the original data as provided to the Department of Mines, Petroleum and Exploration. The Department of Mines, Petroleum and Exploration is not responsible for any error or omission in the data. Confirmation of the content of this plan should be obtained from the relevant agency. The Department of Mines, Petroleum and Exploration is not responsible for any error or omission in the data. Confirmation of the content of this plan should be obtained from the relevant agency. The Department of Mines, Petroleum and Exploration is not responsible for any error or omission in the data. Confirmation of the content of this plan should be obtained from the relevant agency.